



intec
PRINTING SOLUTIONS

colorcut

Dual Tool, Flatbed Digital Die-Cutters

ColorCut FB550 Series

Installation & Setup Guide - English

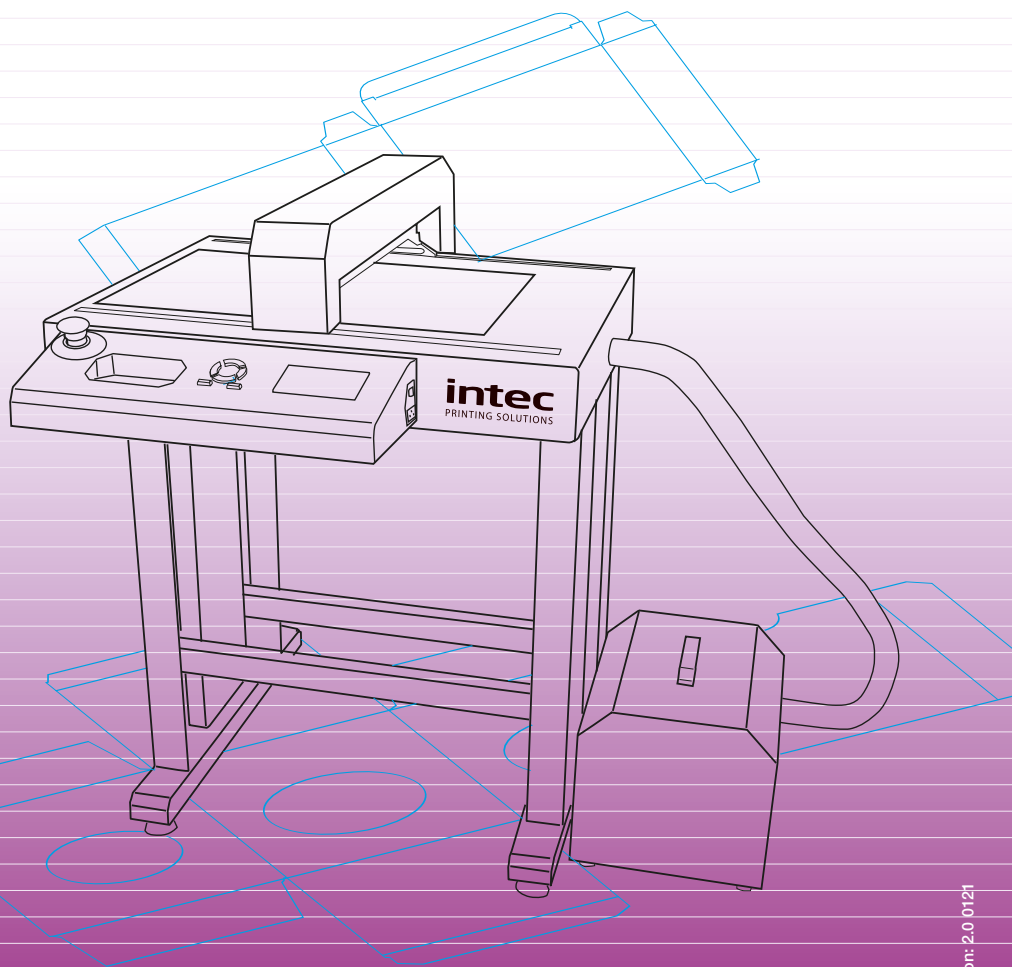

Contents

Chapter 1 -The Intec ColorCut FB550 Flatbed Series.....	5
1.1 INTRODUCTION	7
1.2 SPECIFICATIONS	8
1.3 UNPACKING Contents of the ColorCut (Overview)	9
1.4 UNPACKING Contents of ColorCut Flatbed (Detailed).....	10
1.5 IDENTIFYING KEY FEATURES of your ColorCut Flatbed	11
1.6 THE CONTROL PANEL (Overview of Navigation).....	12
Chapter 2 - TOOLS for the Intec ColorCut Flatbed	14
2.1 CUTTER BLADES (An overview of Blade types)	15
2.2 THE BLADE HOLDER - an introduction	16
2.3 Replacing the blade.....	16
2.4 BLADE LENGTH - (Adjustment).....	17
Chapter 3 - INSTALLATION of your ColorCut Flatbed	18
3.0.1 OVERVIEW of installation steps.....	19
3.1 Assembling the Stand, Cutter and Vacuum Pump	20
Component parts of the stand	20
Component parts of the vacuum fan pump	20
Assembly of stand	21
Assembly of vacuum fan/pump.....	21
3.2 Software Installation - Intec ColorCut Pro	22
ColorCut Pro Overview	22
ColorCut Pro Installation.....	22
3.3.1 Connecting and powering on the cutter.	25
Turning the cutter on (The Initialisation Process).....	25
3.3.2 Connecting to your computer.....	26
3.3.3 CONFIGURING COLORCUT PRO TO MATCH YOUR CUTTER	26
3.3.4 Customising the ColorCut Pro skin to your FB550 cutter	27
3.3.5 Output device	28
3.4 Installing Tools in your ColorCut	29
3.5. Calibration of the FB550 Cutter	30
3.5.1 Calibration of the Creasing Tool to the Cutting Tool.....	30
3.5.2 Calibration of the Sensor Offset to the Cutting Blade.....	34
3.6 Performing a test cut	37
3.5.1 Calibration of the Creasing Tool to the Cutting Tool.....	37

Chapter 1

1.1 Introduction

1.2 Specification

1.3 Unpacking overview

1.4 Identifying key features of your ColorCut Flatbed

1.5 Overview of the Control Panel

1.1 INTRODUCTION

INTEC COLORCUT FLATBED - DIGITAL CUTTING SOLUTION

The Intec ColorCut FB550 flatbed cutters are designed primarily to cut card and packaging materials effectively. It is also used for cutting, vinyl, thin film, adhesive labels and magnetic media.

There are also additional functions for die cutting sheet material, using perforated and dashed cut features and the use of additional tools such as creasing which enables folding on suitable card materials without the fibres on the board breaking when the material is folded.

The ColorCut solution consists of 2 parts:

Hardware

- An Intec Digital Cutting Engine
- An Integrated Optical Sensor for automatic registration mark sensing
- A Stand
- A Vacuum Pump to provide suction for vacuum table.
- An Optional Silencer/Acoustic Muffler to reduce vacuum pump sound levels
- A Vacuum connection hose

and

Software

The ColorCut Pro cutter control software contains two parts, (i) a professional direct plug-in for Illustrator or CorelDRAW enabling you to assign cut lines or paths created from Adobe Illustrator or CorelDRAW. (ii) a Production Studio application that cuts your projects (either from within your graphics package or as a separate application where jobs can be cut later using a job number or barcode).

Jobs can be cut without registration marks, however for accurate cutting your files must contain four reference marks, known as SMARTmarks (described later in the ColorCut Pro Software manual) which can be automatically applied within the ColorCut plug-in.

The optical sensor integrated into your ColorCut hardware detects the SMARTmark in a fraction of a second and adapts the cut path to any variations in the origin, scale or skew distortion of the print.

The software runs with the operating systems Windows 7, 8, 10.

Please use this guide to set up your Hardware and refer to the Software / ColorCut manual to assist you in final calibration of the software to the cutter including guidance on how to use ColorCut Pro when designing and cutting your files

1.2 SPECIFICATIONS

INTEC COLORCUT FLATBED - SPECIFICATIONS

The Intec ColorCut FB550/FB750 and FB1150 series of flatbed cutters vary primarily by the size of the cutting area.

Model	Maximum Media Area	Effective Contour Cutting Area	Stand
ColorCut FB550	350 x 520mm	330 x 488mm	Yes
ColorCut FB750	475 x 670mm	456 x 640mm	Yes
ColorCut FB1150	780 x 1080mm	740 x 1040mm	Yes

In addition to the primary difference in workspace area and the cutting area. The Intec ColorCut FB520/FB600/FB700/FB900 and FB1060 flatbed cutters have different vacuum control systems to provide media hold-down during cutting.

Model	Air Pump Vacuum Power	Vacuum Control	Accoustic Silencer
ColorCut FB550	400W	400W Fixed	Optional
ColorCut FB750	750W	750W Fixed	Yes
ColorCut FB1150	1000W	1000W Fixed	Yes

Each cutter is supplied with 2 different cutting mats that are positioned on the cutting table; the green self healing mat is typically used for kiss-cut applications such as labels/decals or vinyl's. The Grey felt mat is actually the premium mat and is also known as the superior cutting underlay. This is used for cut-through applications and any application using the creasing tool, as the mat enables some 'give' therefore providing a better crease. In addition, the grey superior cutting mat can extend the life of your cutting blade for cut-through applications.

1.3 UNPACKING Contents of the ColorCut (Overview)

Your Intec ColorCut is packed in 1 crate.

The box contains :

The Intec ColorCut Cutting Engine. (Item (i))

The ColorCut Vacuum Pump (ii)

The Vacuum Pump Connector Hose (iii)

The Accessories box (iv)

And the ColorCut Stand (v)

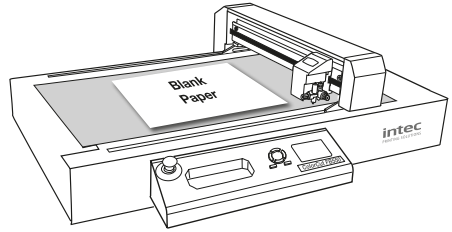

Item (i) - Intec ColorCut Cutting Engine

The ColorCut Vacuum Pump and Vacuum Hose provide the vacuum to hold down your media on the cutting table.

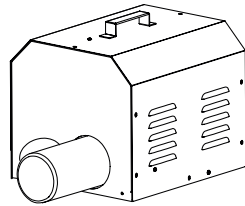

Item (ii) - ColorCut Vacuum Pump
(and Acoustic Silencer - Optional on FB550)

The stand provides a perfect ergonomic working height for your cutter.

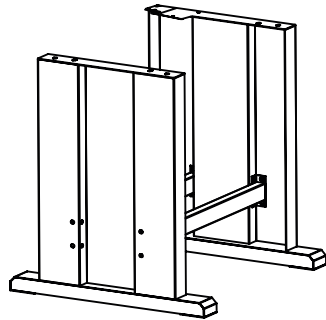

Item (iii) - Intec ColorCut Stand (FB550, FB750, FB1150)

The final items found inside the accessories box include the power cable and USB cable plus a disk containing your ColorCut Pro Software and license code. A Blade Holder, a selection of Cutting Blades, a Calibration Pen Tool and a Creasing Tool.

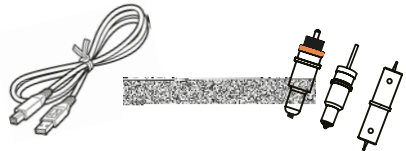

Item (iv) - Manuals, USB & Power Cables

*Optional on FB550

1.4 UNPACKING Contents of ColorCut Flatbed (Detailed)

Item	Qty	Description / Purpose
Intec Flatbed Cutter	1	Main Cutting Engine
Vacuum Air Pump	1	Air fan that provides Vacuum
Hose	1	Connects Vacuum Pump to Cutting Engine
Hose Connector*	2	Connects Hose to Vacuum Pump and to cutting Engine.(FB550 Only)
Software (ColorCut Pro)	1	ColorCut Pro cutting control software - Direct plug-in for Illustrator or CorelDRAW, and stand alone Production cutting applications.
Blade Holder	1	Used for mounting the blades in Tool Holder 1 on the cutting head.
Pen Tool	1	Used in the calibration process for aligning the sensor to the cutting position
Creasing Tool	1	A dual ended, Ball Bearing-based tool to crease the media without breaking the fibres (2 crease widths are possible by using the dual ends)
Blades	3	1 x 30° Blade (Yellow) 1 x 45° Blade (Red) 1 x 60° Blade (Blue)
Circlip Knife	6	3 x 45° Circlip Knife for thicker media (Red) 3 x 60° Circlip Knife for thicker media (Blue)
Self Healing Cutting Mat (Green)	1	Mainly used for cutting (Labels and Swing tickets)
Felt Creasing & Cutting Mat	1	Used to improve creasing effect and extended blade life - Typically cut through / die cut applications- packaging - (cutting and creasing)
USB Cable	1	For connection to the computer
Silencer for Vacuum pump	1	Reduce noise for Vacuum pump FB750/ FB1150 (only) (Option for FB550)
Power Cable	2	1 for Digital Cutting Engine 1 for Vacuum Pump
M3 Six Angle Wrench		Backup tool
M2 Six Angle Wrench		Used to adjust the height of the creasing ball
10A Fuse		/

Please use this guide to set up your ColorCut Hardware.

1.5 IDENTIFYING KEY FEATURES of your ColorCut Flatbed

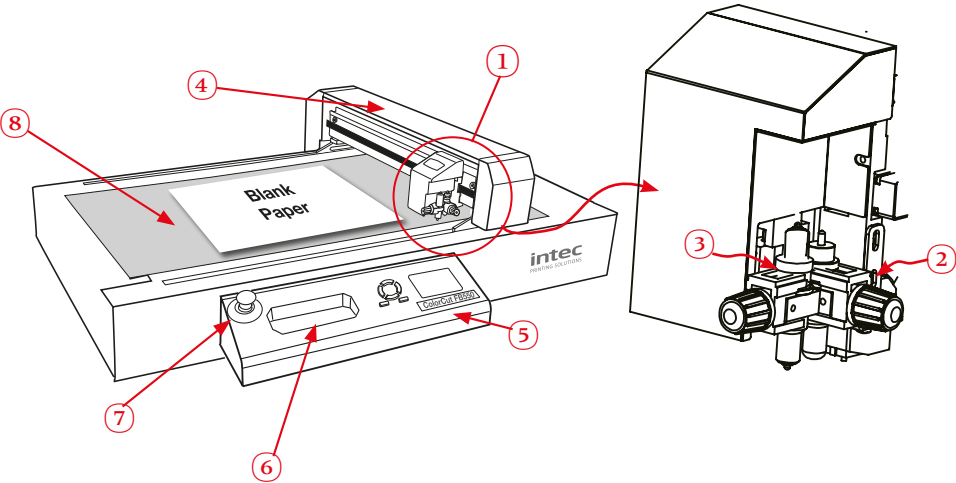

- ① Tool Carriage..... Drives the cutter blade/pen/creasing tool forward/backward.
- ② Tool Holder 1..... Holds the cutter blade tool and drives it up/down.
- ③ Tool Holder 2..... Holds the pen/creasing tool and drives it up/down
- ④ Beam..... Holds the tool carriage; moves left/right.
- ⑤ Control Panel..... Used to set and use the cutter's various functions.
- ⑥ Tool RecessRecess for holding tools
- ⑦ Emergency Switch... In case of emergency turns off the power.
- ⑧ Cutting Area..... Vacuum bed and Contour Cutting Area.

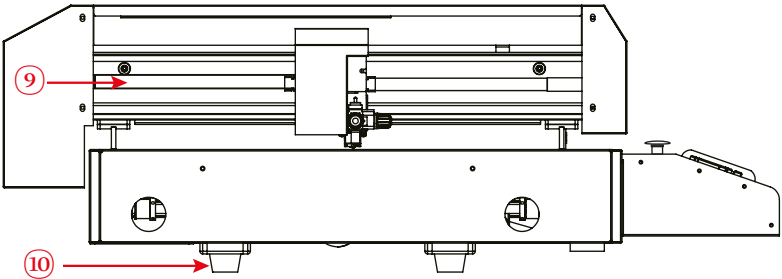

- ⑨ Belt..... Drives the tool carriage forwards and backwards
- ⑩ Stabilisation feet.....Footings for machine when not using the stand.

1.6 THE CONTROL PANEL (Overview of Navigation)

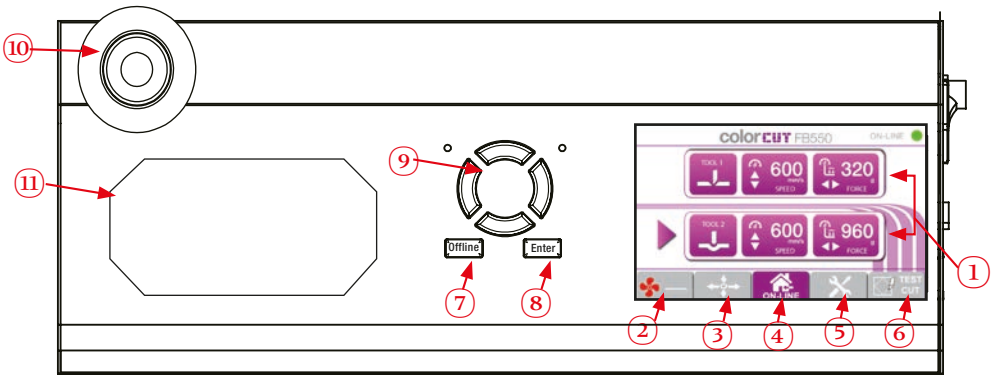

- ① **LED Display** Displays Tool (Cut/Crease) information and menu parameters.
TOOL 1 - SPEED / FORCE - Controls the speed and force of tool holder 1. (Generally used to hold the blade for cutting).
TOOL 2 - SPEED / FORCE - Control the speed and force of tool holder 2. (Generally holds the creasing tool).
 Tap on the screen to select each tool, use the HARD keys (left) to adjust values.
- ② **(Fan)** Toggles the vacuum fan function on/off [] / []
- ③ **/MOVE** Takes the Cutter [Of f-Line] and enables your to move the tool carriage. Used to set the start/origin for cutting and moving the carriage when placing sheets. After moving the tool carriage, you must press ENTER twice if you want to define the position as a new ORIGIN. The MOVE function also enables access to the Sensor light ON/OFF button (enabling you to see the sensor position).
- ④ **(Home)** HOME - Returns back to the main screen.
 (When you use the MOVE function or scroll through the menu options, pressing the [] (HOME) key leaves the screen and returns to the HOME screen.
 (Default Home screen displays: Speed and Force - (for each Tool)
- ⑤ **Menu** Scrolls through the machines menu settings/parameters.
Align Tool2 to Tool1 - Sets the distance between tool holder 1 & tool holder 2. Enabling you to align the CREASE to the CUT. This is not the same as cutting in the correct position (see SENSOR OFFSET) in your software manual for that!
Firmware Version - Displays the current installed version of firmwa e.
Menu Mode - Displays the DEFAULT list (above) or ADVANCED list (below)
Work Mode - Cut Plotter - Enables both tool holder 1 and tool holder 2.
 - Draw Plotter - Enables tool holder 1 (blade/cut) only.
Scaling Factor - Scaling for the X direction and Y direction.
 - Set at the factory and typically does not need to be changed.
Factory Reset - Restores ALL factory default settings.
- ⑥ **Test** Used to make a Test Cut to check whether the currently selected cutting conditions are compatible with the media loaded. Tool 2 creates a 45° rotated square (Like a diamond), then Tool 1 cuts a square around it. Using a Test Cut you can check Blade Depth and pressure for cutting and also confirm if the creasing Tool is perfectly aligned to Cutting Tool.

THE CONTROL PANEL (Overview of Navigation)

⑦ **Offline** When the Default Home screen is displayed, the **OFFLINE** key takes the cutter offline. In this mode you cannot send jobs to the cutter.

Pressing the MOVE key will also place the cutter of f-line. You can move the carriage - remember after moving the carriage, press ON-LINE to place the cutter back on-line and enable jobs to be received.

⑧ **Enter** After setting a function or condition in the MENU options [✂], press the [ENTER] key to register your setting

⑨ **←↑→↓** Hard button arrow keys used to INCREASE or DECREASE values on the LCD panel screen. Either for TOOL speed/force control OR for changing menu settings or parameters.



The LCD screen will often indicate which key to use to increase or decrease the value. i.e. When tool 1 is selected, the $\Delta \nabla$ are displayed next to the SPEED parameter, indicating you should use the $\uparrow \downarrow$ keys. The $\triangleleft \triangleright$ symbols are displayed next to the FORCE, indicating the $\leftarrow \rightarrow$ Keys are used to adjust these values.

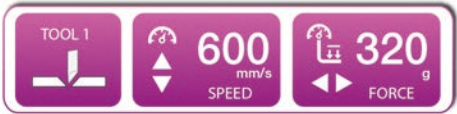

⑩ **Emergency switch** Cuts the power to the cutter. Depress again to deactivate.

⑪ **Tool Recess** Convenient place to store tools.

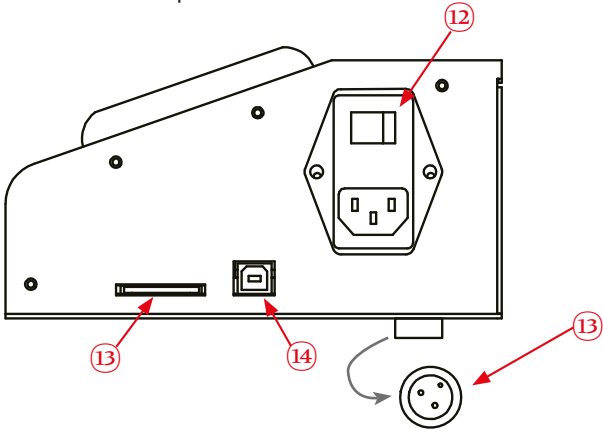

⑫ **Power switch** Turns the ColorCut Digital Cutter ON/OFF.

⑬ **Vacuum pump connector** The control cable connector for the Vacuum pump.

⑭ **USB interface connector** Used to connect the cutter to a computer via the USB interface.

⑮ **SDcard interface connector** N/A - This feature is unavailable.

Chapter 2

2.1 Types of cutter blades





2.2 Blade Holder introduction

2.3 Replacing the blade

2.4 Blade length (Adjustment)

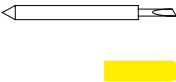
2.1 CUTTER BLADES (An overview of Blade types)

Your cutter comes with a selection of blades. The blades are packed in a foam packing material. In addition to this there is a colored rubber protective cap. The yellow caps indicate 30°, red caps indicate a 45° blade while the blue caps are 60° blades. Be careful when handling the blade as the cutting end is very sharp. Blades are selected for different applications; a guide is shown below:

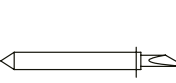
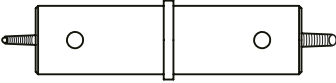
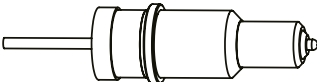
Name	Image	Angle	Blade Diameter	Features and Application
Blade		30°	1mm	For Film, very soft material, thin label material.
		45°	1mm	Typically for labels, stickers, and thin paper/card,
		60°	1mm	For thick media. The sharply angled tip provides a longer cutting edge. Suitable for cutting media from 0.5 to 1.5 mm thick.*
Circlip Knife		45°	1.4mm	Most packing board up to 500 micron. Circlip provides better pressure and improves blade direction changes on dense media. Suitable for cutting media from 0.25 to 0.5 mm thick
		60°	1.4mm	For cutting high-intensity reflective film, magnetic media or thick media. The sharply angled tip provides a longer cutting edge. Suitable for cutting media from 0.5 to 1.5 mm thick.* For cutting sandblast rubber.
Creasing Blade				Bearing-based creasing ball, double-ended for different width creasing. Suitable for media ≤500g Cardboard, corrugated paper
Pen Holder				Used at setup, to calibrate the offset between the Optical Registration Mark sensor (Red light) and the centre of Tool1 (The blade).

* Maximum cutting depth is defined by the machine type rather than the blade (which is 600 mic ons)

2.2 THE BLADE HOLDER - an introduction

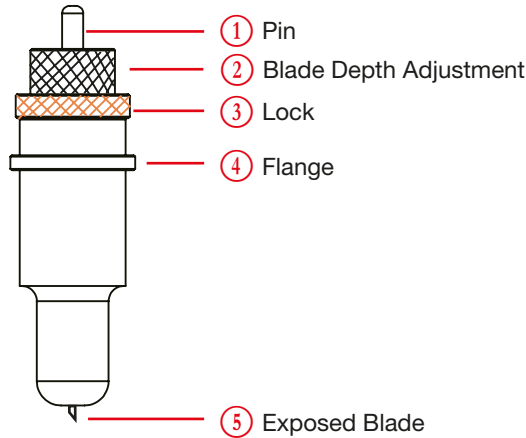
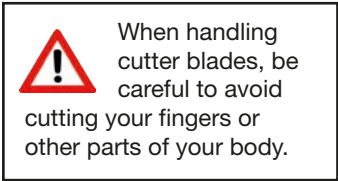

2.3 Replacing the blade

The blade is a consumable item and you'll always get the best quality cut with a newer blade. Please replace with a new blade when the cut quality reduces.

For Standard blades

(Without the circlip)

1. Push the blade into the bottom of the blade holder.

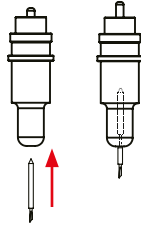

2. Adjust the amount of exposed (visible) blade tip to a suitable length by rotating ② the "Adjustment depth knob" and then tighten the lock ③.

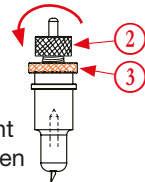

3. Press the push-pin ① to remove the blade from the blade holder when replacing blade



For CirClip Blades

1. Unscrew the lower (cover) part of the blade holder.

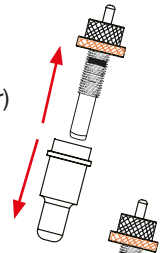

2. Insert the CirClip blade into the inner blade holder. Then replace the outer cover of the blade holder;

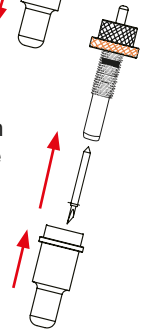

3. Adjust the amount of exposed (visible) blade tip to a suitable length by rotating ② the "Adjustment depth knob" and then tighten the lock ③.

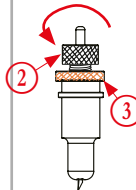

4. Replace the blade by following the steps above (Note: You cannot push the pin as you do with standard blades as the circlip prevents the blade being removed.

2.4 BLADE LENGTH - (Adjustment)

Blade Depth is a major factor in how well the machine cuts and along with the downforce / pressure, determines how cleanly the material cuts and how easy or difficult it will be to 'weed' the material. Too much blade depth is as bad as not enough.



If you have enough blade sticking out to clearly see and feel the tip, it's probably too far out. Most new Intec Flatbed cutter owners improperly install the blade with too much of it protruding from the holder. Set it so that you can barely see the tip.

Then take the blade holder and manually drag it across a sheet of card or label that you wish to cut, making a box pattern or square.

Card: Lay a scrap piece of material on a hard work surface with 2 sheets of copier paper underneath, (not on a nice table in case you cut through paper underneath). With the blade holder in your hand, press down and cut a circle in the material. Press down using a moderate amount of force while you cut the circle. You will not be able to cut through the second sheet of paper when the blade depth is set correctly. If it cuts through the second sheet then the depth is too much and you need to retract the blade.

Labels: Lay a scrap piece of material on a hard work surface (not on a nice table in case you cut through the backing). With the blade holder in your hand, press down and cut a circle in the material. Press down using a moderate amount of force while you cut the circle.

Adjust the blade depth so that only traces of the blade's cut appear on the backing sheet when a cutting test is performed. You will not be able to cut through the material backing when the blade depth is set correctly. If it cuts through the backing then the depth is too much and you need to retract the blade.

The blade length is adjusted by turning the blade adjustment knob.

- To extend the cutter blade, turn the knob in the (A) direction.
- To retract the cutter blade, turn the knob in the (B) direction.

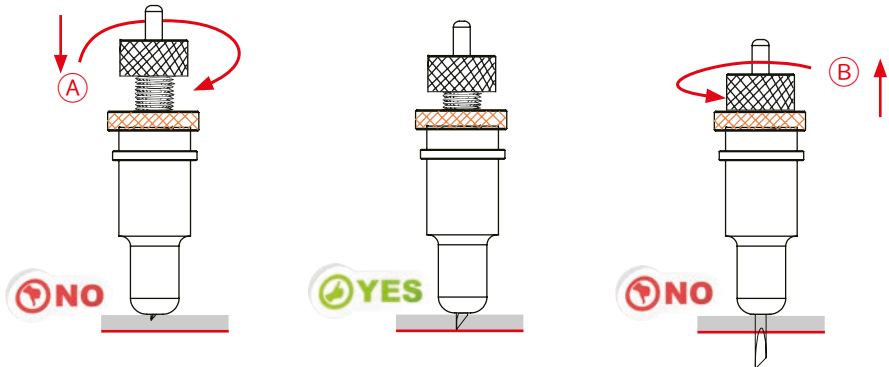

INSTALLATION overview

3.1 Basic overview of installation steps

3.2. Parts for assembly

3.2.1 Stand components

3.2.2 Vacuum Pump components

3.3.1 Assembly of the stand and cutter

3.3.2 Connecting the Vacuum pump

3.4. Connecting and Power on the Cutter

3.4.1 Turning on the Cutter

3.4.2 Connecting to a Computer

3.5 Installing Tools

3.6 Calibration of the Creasing Tool to the Cutting Tool

3.7 Calibration

INSTALLATION START

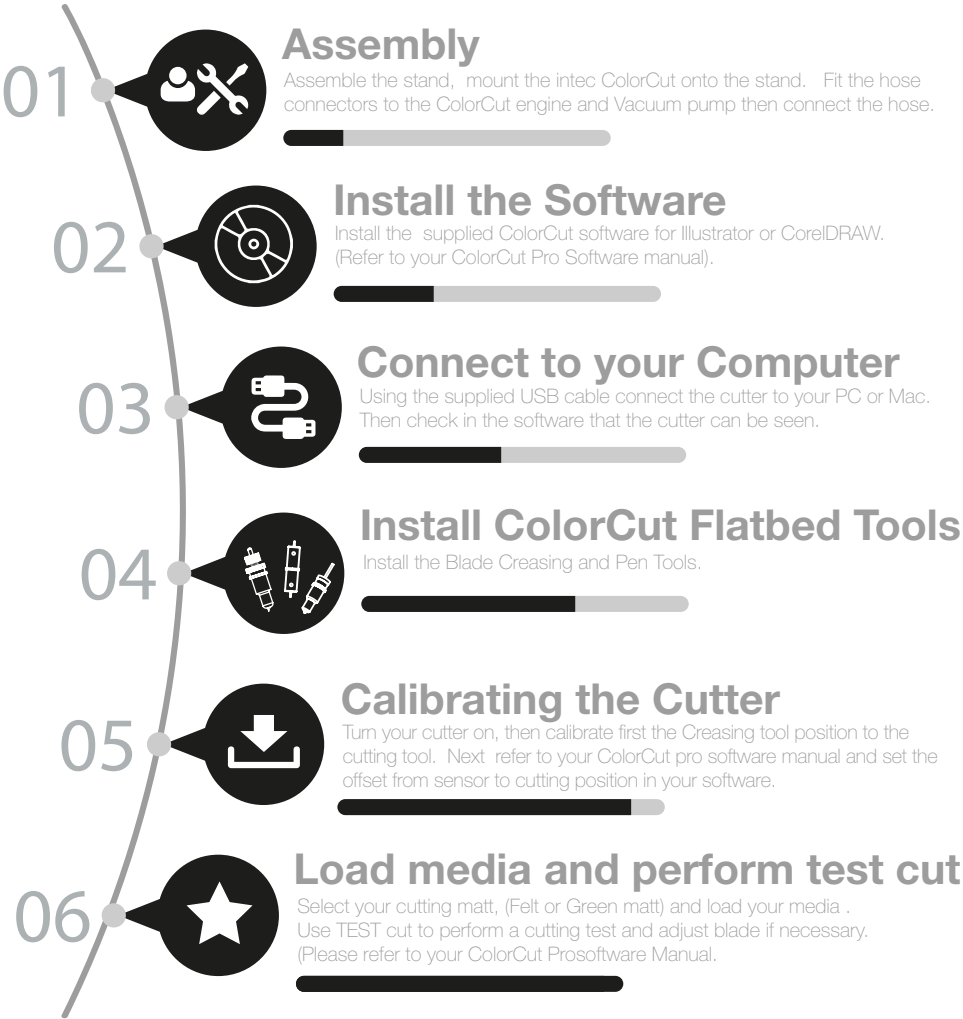

INSTALLATION FINISHED

3.1 Assembling the Stand, Cutter and Vacuum Pump

Component parts of the stand

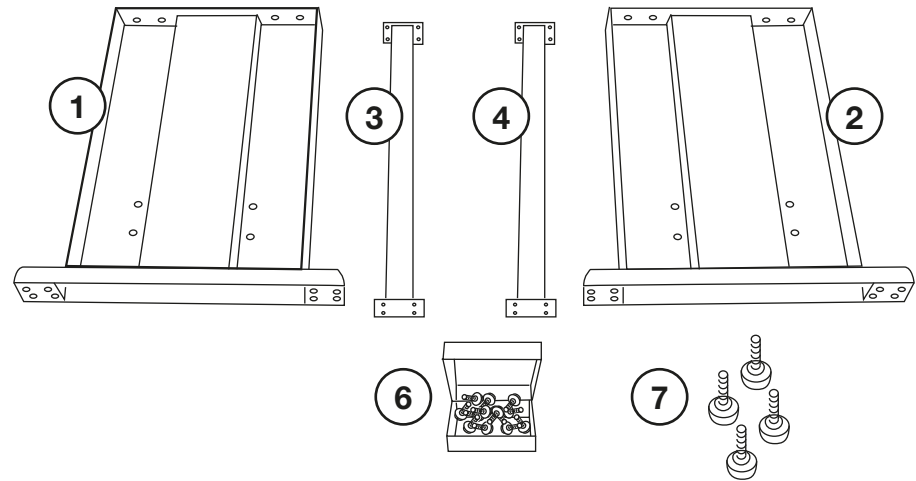

- | | | |
|-------------------------|-----------------------|---------------------------|
| 1. Left side panel/leg | 3. Front cross member | 6. Castors x 4 free-wheel |
| 2. Right side panel/leg | 4. Rear cross member | 7. Bolt, washers, fixing |

Component parts of the vacuum fan pump

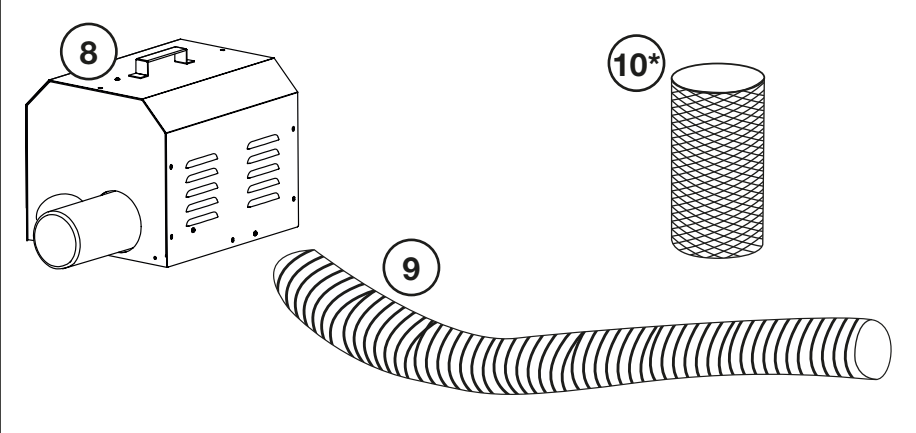

- | | |
|------------------|---------------------------------|
| 8. Acoustic pump | 10. Silencer (*Option on FB550) |
| 9. Flexible hose | |

3.1 Assembly of the Stand and Connecting the Vacuum Pump (cont)

Assembly of stand

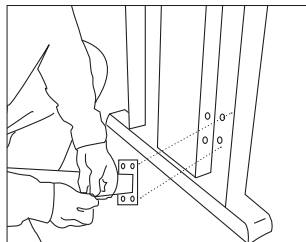

Locate one side panel, both cross members and Bolts

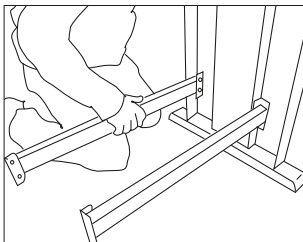

Using the black bolts to attach the cross members.

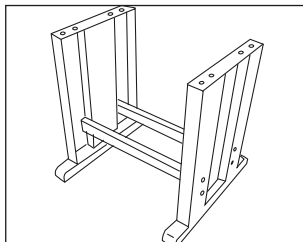

Then attach the other side panel using same method.

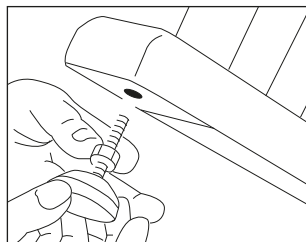

Screw the stand feet into the bottom of side panels

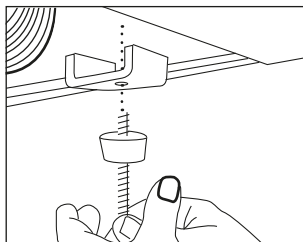

Remove the Rubber feet from the base of Flatbed.

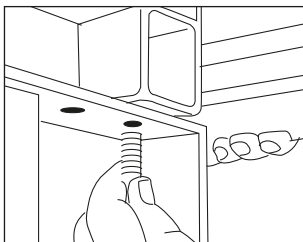

Locate the Flatbed on the stand and fix with bolts.

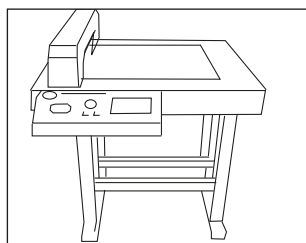

Tighten all bolts with Allen key supplied.

The assembled unit

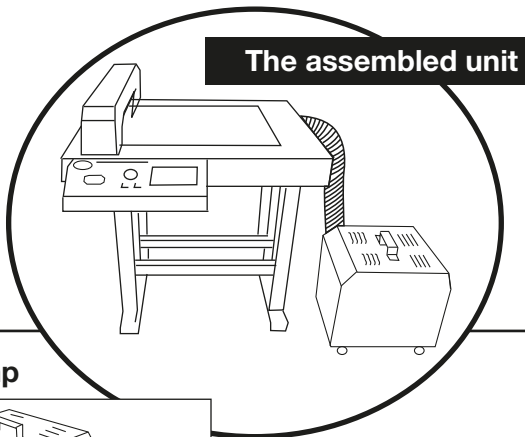

Assembly of vacuum fan/pump

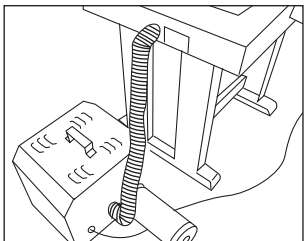

Connect vacuum hose
(FB550 use supplied connectors)

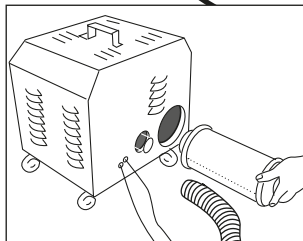

Attach Silencer
(Optional for FB550 models)

3.2 Software Installation - Intec ColorCut Pro

ColorCut Pro Overview

The Intec ColorCut Pro software is a professional cutting package that works directly from Illustrator or CorelDRAW. The plug-in requires Adobe Illustrator® or CorelDRAW® to be installed.

Intec ColorCut Pro™ gives you the ability to send projects you've designed in Adobe Illustrator® or CorelDRAW® straight to your Intec ColorCut Flatbed. The plug-in allows experienced Illustrator® or CorelDRAW® users to skip SignMaster® enabling a much faster entry into using your Intec ColorCut with no need to learn a new application.

Intec ColorCut Pro Software for your Intec ColorCut Flatbed is supplied on the included CD, however it may also be downloaded from our website <http://intecprinters.com/support-downloads/drivers-downloads/colorcut/>



Please note:

You require Illustrator (MAC or PC) or CorelDraw (PC Only) to create cut lines and cut your projects. Please ensure one of these packages is installed prior to proceeding.

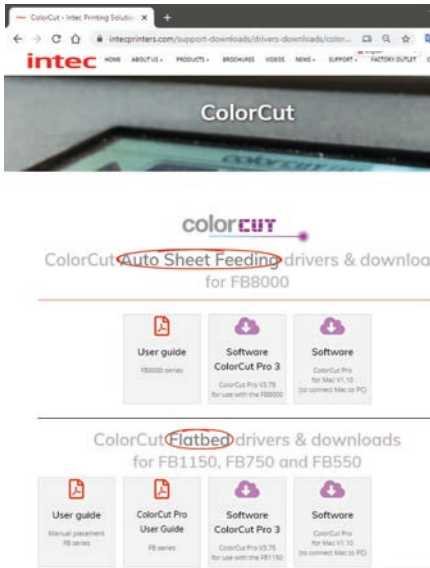

ColorCut Pro Installation

Please run the installation program:
SetupColorCutPro.exe

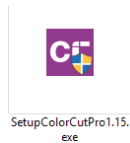

The setup program requires various confirmations for the installation of the program.

On some computers you could be asked the system administrator's password to execute the installation. In the case THAT you do not have this information; contact the technician who administrates your system.

3.2 Software Installation - Intec ColorCut Pro (Cont.)

In some instances, (depending on your PC configuration) Windows 10 users may see a security warning appear, as this is not a Microsoft application.

Do not worry , this is perfectly normal. Click more info .



The dialogue box will confirm the App. you are installing is the ColorCut Pro App.

Click [RUN ANYWAY]

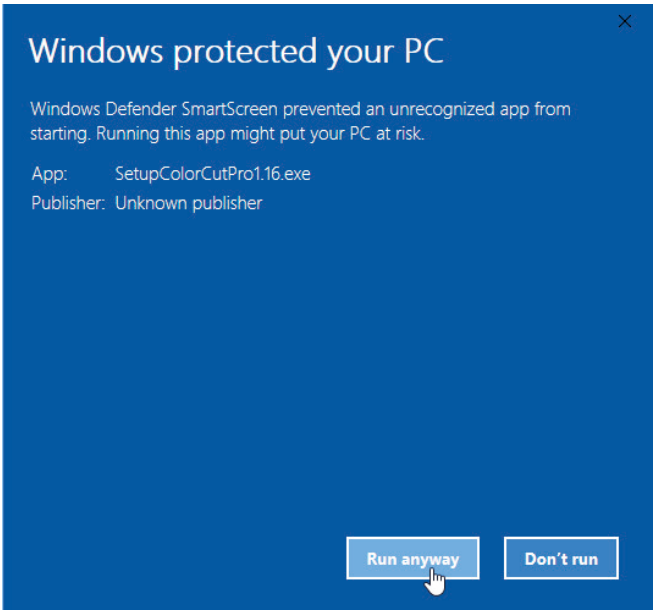

3.2 Software Installation - Intec ColorCut Pro (Cont.)

To start the installation of the ColorCut Pro software, simply click the [NEXT>] button.

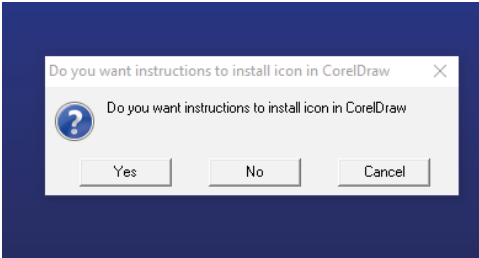
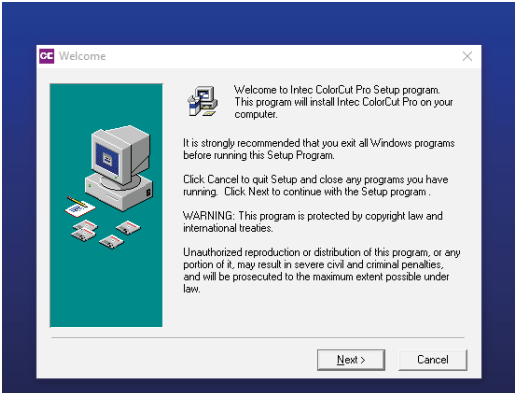

If Illustrator is installed on your computer, please ensure it is not open and running, otherwise, after the installation you will be asked to restart your system before starting ColorCut Pro.

By default the ColorCut Pro plug-in software will automatically install into Adobe Illustrator if it is installed on your computer.

If you have CorelDraw then the Plug-in for CorelDraw will also be installed at this time. **If you have CorelDRAW, SKIP to the next page.**

If you have Adobe Illustrator, then when the installation has finished click [NO] on the dialogue box asking you if you wish to review the CorelDRAW installation instructions.

You should now advance to section 3.3 (Connecting to your computer) in this manual.

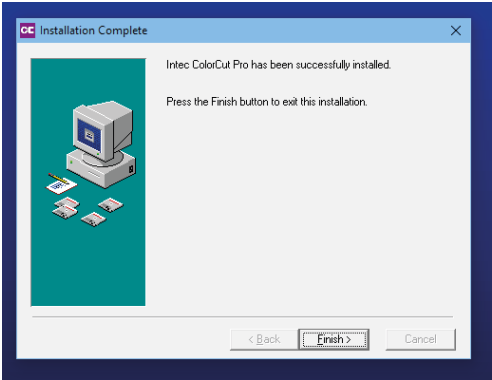

3.3.1 Connecting and powering on the cutter.

Turning the cutter on (The Initialisation Process)

1. Connect the control cable for the Vacuum Pump to the Vacuum Pump control jack on the underside of the control panel. 1. Securely plug the power cord into the mains socket 2 on the control panel and connect to an electrical outlet of the specified voltage.

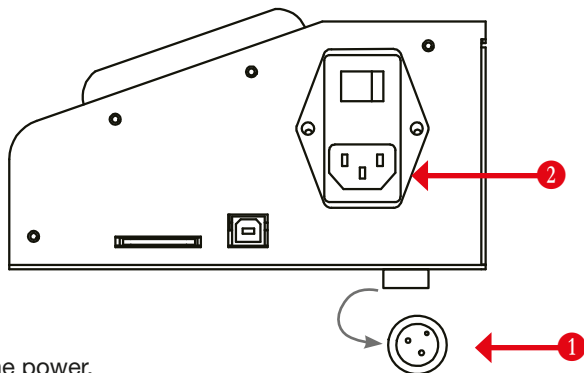

2. Turn on the power.

3. The green power lamp 3 on the control panel will light, the LCD display 4 will illuminate. A Safety message will appear on the LCD panel asking your to press the [ENTER] key to continue.

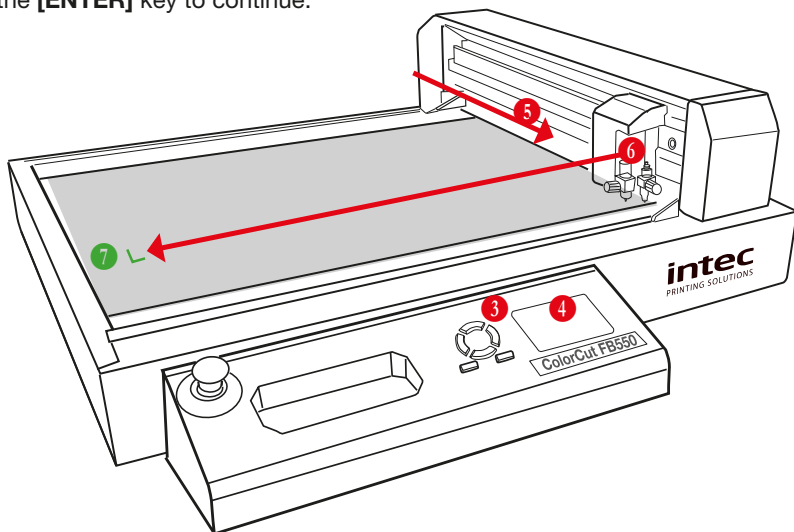

4. Next the Intec ColorCut Flatbed digital cutter will move the Tool Carriage 5 to the closest point as shown in the figure above and then the beam 6 will move to the ZERO point (furthest left point as indicated with the green 7 mark above).

These operations are part of the initialisation process; once the Tool Carriage has moved to the front point and the beam to the furthest left point (The cutter has determined the ZERO Origin point) and the display will change to display the HOME screen and the cutter is ready for use. (Ensure the Cutter is ON-LINE before proceeding).

3.3.2 Connecting to your computer

The Intec ColorCut Pro software includes the USB drivers built into the cutter software. There is no need to install any addition drivers.



Please note, that operation can not be guaranteed in the following circumstances:

- 1) When connection is made through a USB hub or an add-on USB board.
- 2) When you are using a custom-built computer that has been modified
- 3) When other USB devices such as USB printers are conencted.

For optimal results, please ensure the following:

- Do not connect or disconnect the USB cable while you are installing the Intec ColorPro software.
- Do not connect or disconnect the USB cable while starting up the computer.
- Do not connect or disconnect the USB cable while switching on the cutter
- Do not disconnect the USB cable within a 5 second period of connecting it. (It does not always recognise the fact it was subsequently disconnected and won't reconnect again until you power-cycle both devices)
- Do not disconnect or connect the USB cable while you are cutting a job, or while data is being transferred.

3.3.3 CONFIGURING COLORCUT PRO TO MATCH YOUR CUTTER



The ColorCut software supports a number of different Intec cutters. After the software installation you need to specify the FB550 cutter to allow ColorCut Pro to customise it's configuration to match your FB550 cutter. Therefore it is important you follow the instructions below before the first use of your FB550 with ColorCut Pro and set the DEVICE TYPE to "Intec FB550" to ensure that the ColorCut Pro application, all settings/messages and screens displayed are applicable to your cutter.

To configure ColorCut Pro to match your cutter you will need to launch the ColorCut pro application, and sett he cutter within the [SETTINGS] option.

- 1 Open ColorCut Pro from Windows menu

Open the Windows [START] menu  and select ColorCut Pro from the Programs/Intec folder.

The ColorCut Pro splash screen will briefly appear, then the main ColorCut Pro application will be displayed.

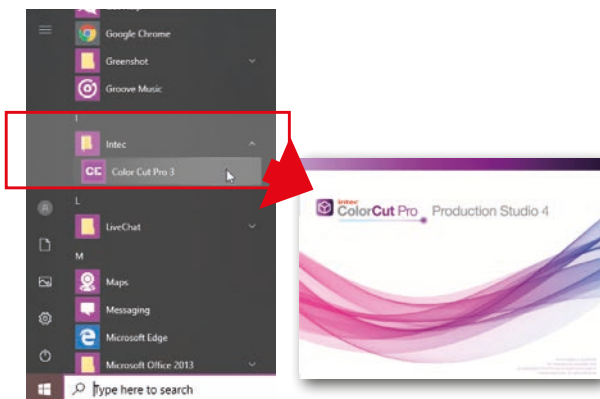

3.3.4 Customising the ColorCut Pro skin to your FB550 cutter

ColorCut Pro supports a number of different Intec cutters with different registration sensing methods, number of tools and manual or autofeeding methods. Therefore various ‘Skins’ which display options and screens will be unique to your specific cutter model and its features (i.e. the FB550). The Settings Button **1** opens a dialogue box which displays the current configuration settings and enables you to set or change the Cutter “Device Type” / skin that ColorCut Pro has been customised to match. Depending on the current selection, your main screen may look like **5a** or **5b**.

2. Click the [SETTINGS] button to open the settings dialogue window.

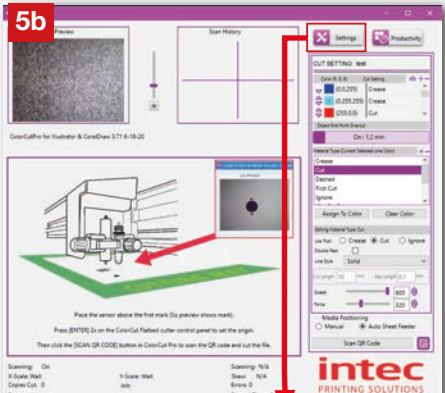
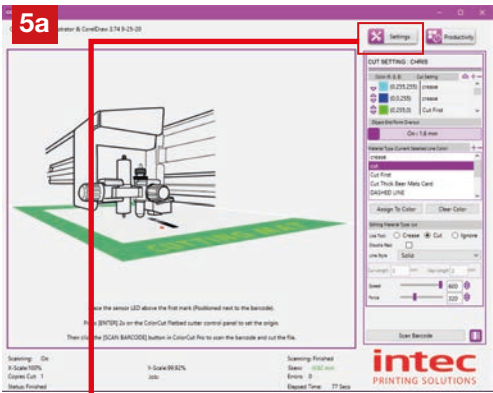

3. The “Device Type” **1** setting shows the type of Intec Cutter that ColorCut Pro is configured to.

The appearance of the main screen layout, Productivity controls, dialogue boxes and Tool controls will change based upon the “**Device Type**” selected, and not all features will be available as detailed in this manual unless you have selected the cutter type to match your Intec FB550 Model.

To ensure ColorCut Pro displays correctly to match the FB550 with an LCD touch panel screen, please set the cutter type to **FB550**.

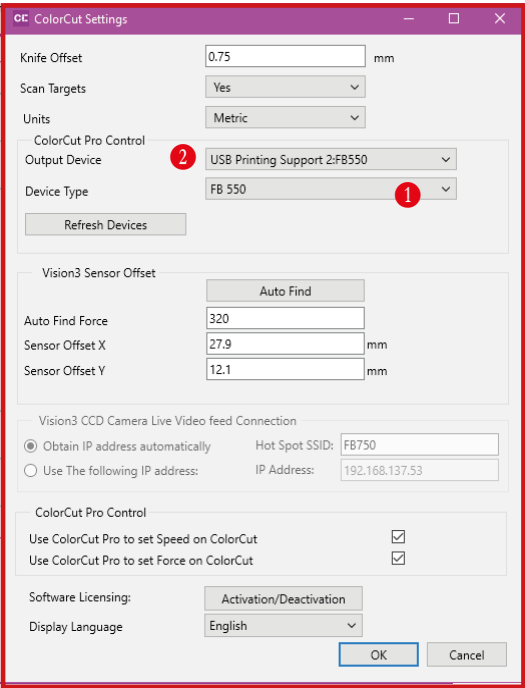

3.3.5 Output device

Check your cutter is connected to and recognised by your computer.

If the Intec ColorCut Pro software cannot sense an Intec ColorCut Flatbed cutter on the USB connection of your computer , then under the “Output Device” option in the [SETTINGS] window it will show: “File Output”.

In such circumstances, check your connection to your computer and power cycle your Intec ColorCut Flatbed cutter. (Ensure it is off for 45 seconds to enable the USB cache to flush). Check that you have cleared the SAFETY MESSAGE that appears at power on, on the LCD panel of the cutter AND that the FB550 cutter is **ON-LINE**.

If the connection to your cutter is successful then under the Output Device option ② you will see the term USB Printing Support.

(After a short delay , the identifier ‘FB550’ may appear after the description ‘USB Printing Support’. However you don’t need to wait for this and this may take a few minutes to appear).

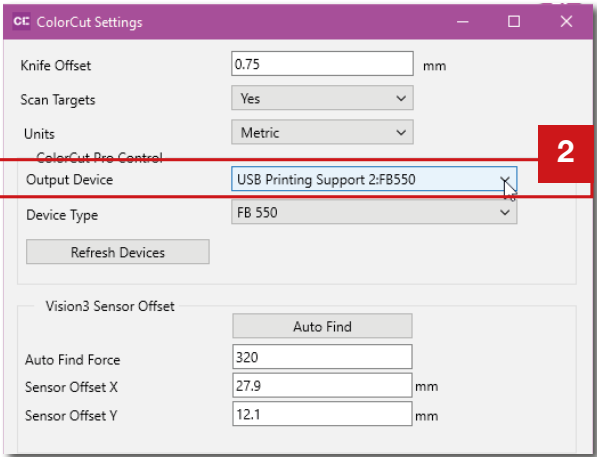

NOTE: The FB550 must be **READY** and **ON-LINE** for the ColorCut Pro software to communicate to it and establish what type of cutter it is. The device may be seen as USB Printing Support and will not show the device name if the cutter is off-line check the cutter is On-Line before sending any jobs.

3.4 Installing Tools in your ColorCut

The tool carriage is mounted on the beam that travels across the cutting area.

It contains 2 tool holders enabling 2 different tools to be mounted at the same time for different operations'

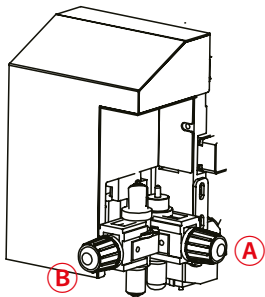

The Tool Holder (A) closest to the Beam, holds TOOL1, typically the cutting blade.

The tool holder furthest away from the beam (B) holds TOOL2 (typically the Creasing Tool).

1. To install a tool into your Intec ColorCut Flatbed, loosen the tool holder's thumb screw (C) sufficiently to enable a blade holder / creasing tool or calibration pen to be inserted up to its flange

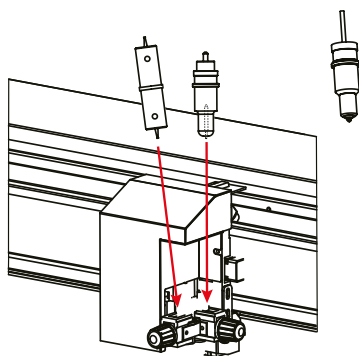
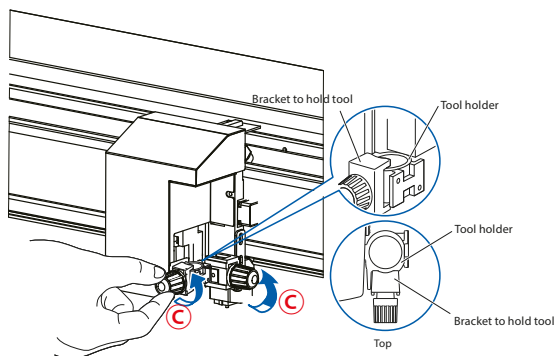

2. Push the tool, i.e. the Blade Holder, Creasing Tool or Calibration Pen all the way into the tool holder until its flange completely touches the upper part of the holder

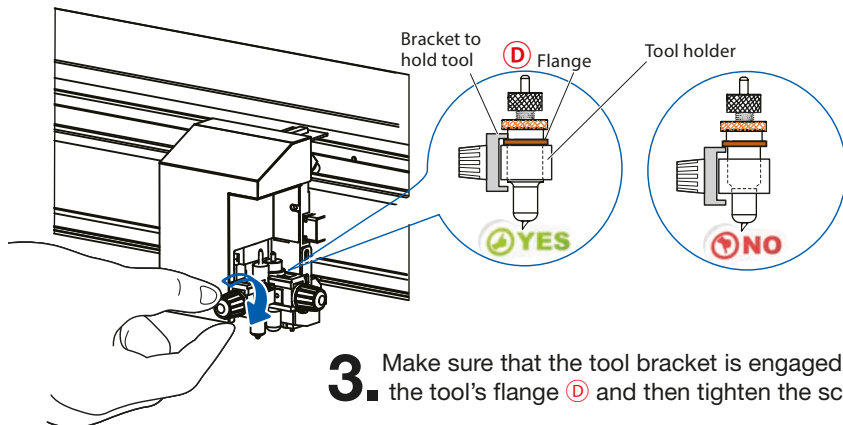

3. Make sure that the tool bracket is engaged on top of the tool's flange (D) and then tighten the screw.

3.5. Calibration of the FB550 Cutter

The Intec ColorCut Flatbed engine needs to be calibrated before the first use to ensure accurate cutting. There are 2 different calibrations that should be performed.

First (**Section 3.5.1**), is to calibrate Tool2 (The Creasing Tool) to Tool1 (The Cutting Tool). This calibration is performed using the front control panel of the cutter and aligns the cutting and creasing tools together.

If the Creasing Tool is NOT calibrated to the Cutting Tool, then your elements may cut correctly BUT the crease will be performed in the wrong position.

The second calibration (**Section 3.5.2**), aligns Tool1 (The Cutting Tool) to the position of the Optical Sensor that reads the Page 'SMARTMarks'. This calibration is performed using the ColorCut Pro software and is known as the Sensor Offset.

If the SENSOR OFFSET is not calibrated then your cut position may be offset from the position on the sheet that you actually wish to cut.

Calibrations are only required upon first use and normally do not need to be carried out subsequently.

3.5.1 Calibration of the Creasing Tool to the Cutting Tool

The Intec ColorCut Flatbed engine is fitted with two tools. Before using your cutter for the first time, you must align the two tools together so that cut lines and creases are in alignment with each other. To calibrate/align Tool2 with Tool1, the cutter will draw a 45° rotated square using the Creasing tool and then use the PEN Tool to draw a square around it. The rotated square SHOULD fit perfectly inside the normal square. Please follow the steps below to calibrate the Cutting Tool to the Creasing Tool.

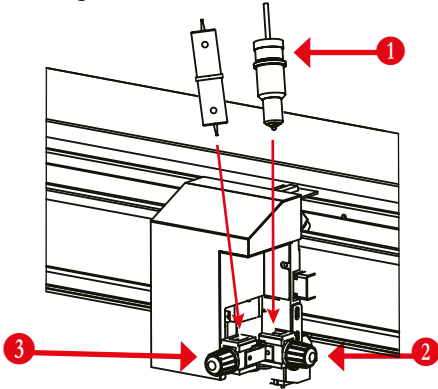

1. Place the Calibration Pen Tool 1 in to Tool Holder 1 2. (Normally the position for the Blade Holder). Then place the Creasing Tool into Tool Holder 2 3.

2. Using the LCD control panel on the cutter, press the **MOVE/**  Tab icon along the bottom of the display.

Using the **Left / Right keys** move the carriage so that you can place a sheet of paper on the cutting bed.

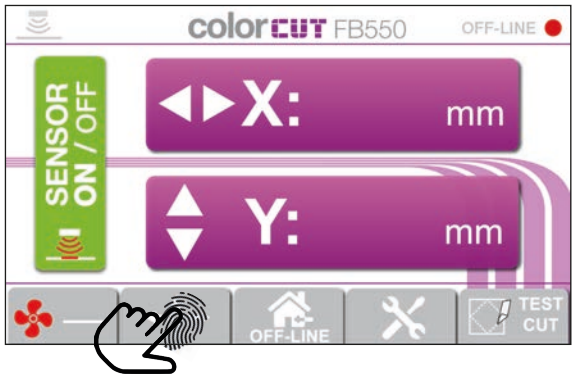

3.5.1. Calibration of the Creasing Tool to the Cutting Tool

3. Place a Blank sheet of A4
./ US Letter paper in the
middle of the cutting table.

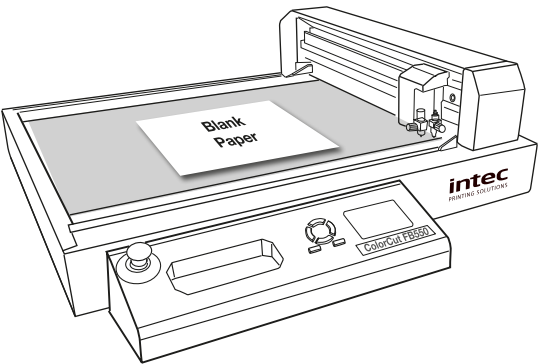

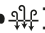
4. Turn on the vacuum hold, by
pressing the Vacuum Tab []
(Fan) key on TAB strip at the base of the
LCD control panel.

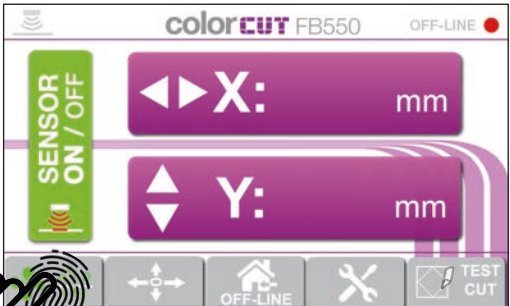

5. Using the **Left / Right** physical
keys move the beam over the sheet
of paper then using the **Up / Down**
keys move the **Tool Carriage** to the
middle of the piece of paper.

With the Tool Carriage in the middle of
the sheet of paper , press the
[ENTER] key twice to set a new
ORIGIN point (When you press ENTER
key the second time, TOOL2 will briefly
activate to confirm).

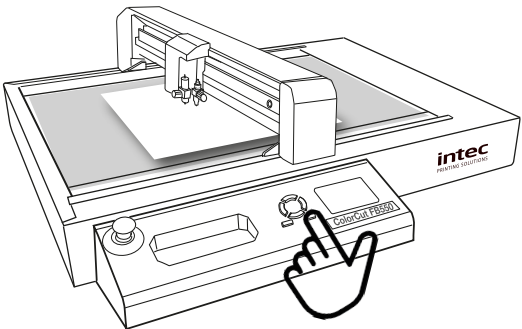

After pressing [ENTER] 2x the display
will return to the HOME screen showing
the Tool's and their Speed and Force
settings.

3.5.1 Calibration of the Creasing Tool to the Cutting Tool (cont)

- 6.** Set the pressure for the Creasing Tool so that it is easy to see the crease.

(In step 5 you pressed **[Enter]** twice so the display should now show HOME SCREEN- If the display is showing MOVE X: xx, Y:xx, then press the **[ENTER]** x2 key to bring the cutter back online.)

Press the 'touchscreen' panel on TOOL2.



Then use the UP / DOWN keys to set the speed (to 300mm/s)) and use the Left / Right keys to set the Force. (to 960 g)

Then press the **[ENTER]** key to accept the settings.

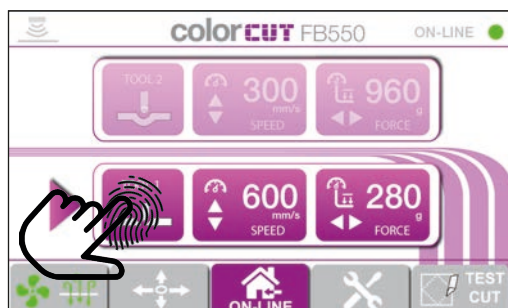

- 7.** Set the appropriate pressure for the Calibration Pen Tool (not too much pressure or you may break the pen).

Press the 'touchscreen' panel on TOOL1.

Use the UP / DOWN keys to set the speed. (to 600mm/s))

Use the Left / Right keys to set the Force. (to 280 g)

Then press the **[ENTER]** key to accept.

- 7.** Now press **[MENU]** Tab button on the bottom of the LCD display to open the menu/setting screen.

- 8.** Ensure the "Align Tool2 to Tool1" is selected (has the arrow next to it, and click the **[ENTER]** key to select.

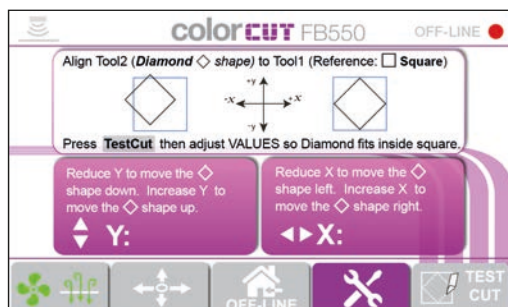



- 9.** The "Align Tool2 to Tool1" screen will appear to guide you through the calibration.

3.5.1 Calibration of the Creasing Tool to the Cutting Tool (cont)

- 10.** Click the  [TEST CUT] tab button on the tab strip across the bottom of the LCD screen.

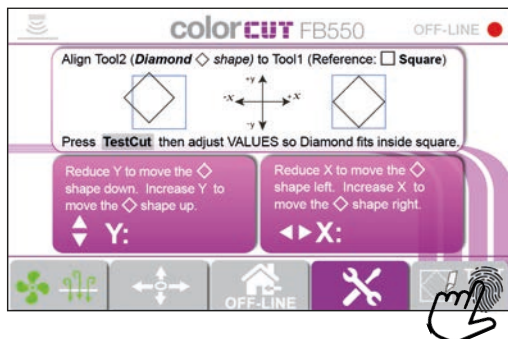
Tool2 (The Creasing Tool) will crease a box at 45° rotation  (a Diamond shape). Tool1 (The Calibration Pen) will then draw a BOX around the Diamond shape.



- 12.** When it has finished drawing the box and creasing the second box, press the **MOVE/**  TAB to display the MOVE X: Y ; SCREEN and use the Left/RIGHT arrow keys to move the beam and tool carriage so you can review the shapes drawn/creased.

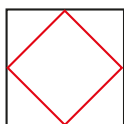
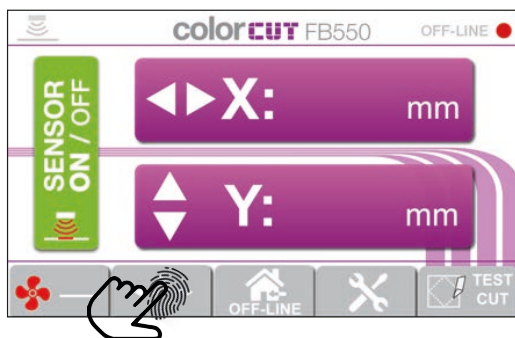
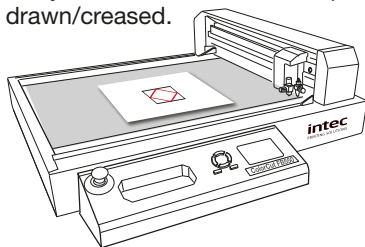

- 13.** If both tools are aligned the creased box will fit perfectly inside the DRAWN box. If they do, Tool2 is aligned to Tool1 please press the **HOME** tab key and continue to section 3.5.2 (Calibrating the Sensor Offset)

If they are not aligned perfectly, continue as detailed below to adjust the alignment.

- 14.** Press the  [MENU] Tab button on the bottom of the LCD display, ensure "Align Tool2 to Tool1" is selected (has the arrow next to it, and click the [ENTER] key to return to the Align Tool2 to Tool1 calibration settings.

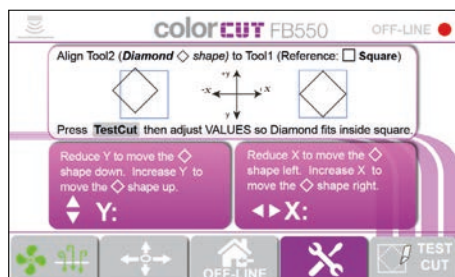

- 15.** Using the arrow keys, (Left / Right) to adjust the X value to move the position Left or Right across the Table. Use the Up/Down keys to adjust the value of the Y parameter to move the position towards the operator or away from the operator. Press the [Enter] key to accept your values. Repeat from Step.4 until you achieve a perfect fit between the two tools.

(Remember to select a new origin each time to avoid making a test in the same position. Do this by using the MOVE menu to move the tool carriage over your paper and pressing [Enter] twice to select the new origin)

3.5.2 Calibration of the Sensor Offset to the Cutting Blade

The Intec ColorCut FB550 Flatbed engine includes a Vision2 - ARMS system (AutoMatic Registration Mark Sensor). The Vision2 ARMS system uses an optical sensor to automatically detect Registration marks, enabling accurate positioning and so ColorCut Pro can adapt cutting lines to compensate for any scale or skew errors.

The Vision2 ARMS sensor is mounted in a different position to the centre of your cutting blade. To cut accurately you must calibrate the distance the Sensor is offset from the cutting blade (Calibrating the Sensor offset) using the ColorCut Pro software application.

NOTE: The sensor offset value is stored within the software application, so you change computers or re-install your computer, you will need to perform the calibration again.



To make calibration easy, ColorCut Pro can automatically perform the calibration for you using the **PEN CALIBRATION TOOL**. The pen tool is used to draw lines that are used to define the centre point of the cutter blade, then the Vision2 ARMS sensor reads these back and the software calculates the offset automatically for you.

- 1.** Place the Calibration Pen Tool **1** Into Tool Holder **1** **2**. (Normally the position for the Blade Holder). Then place the creasing tool into Tool Holder **2** **3**.

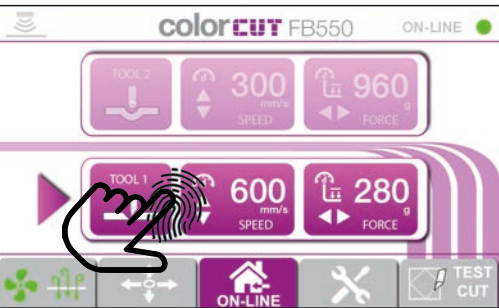
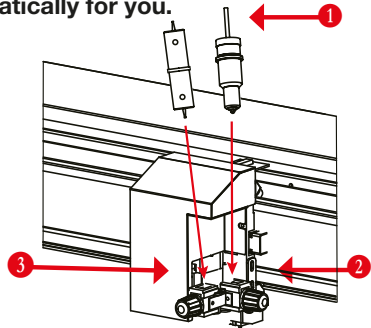

- 2.** Set the appropriate pressure for the Calibration Pen Tool.

Not too much pressure or you may break the pen.

Press the 'touch-screen' panel on **TOOL1**.

Use the UP / DOWN keys to set the speed. (to 600mm/s))

Use the Left / Right keys to set the Force. (to 280 g)

Then press the **[ENTER]** key to accept.

- 3.** Press the **MOVE/**  Tab icon along the bottom of the display.

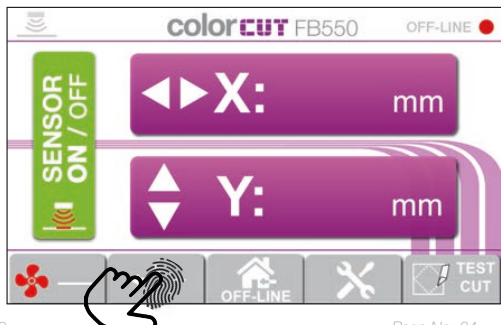

Using the **Left / Right keys** move the carriage so that you can place a sheet of paper on the cutting bed.

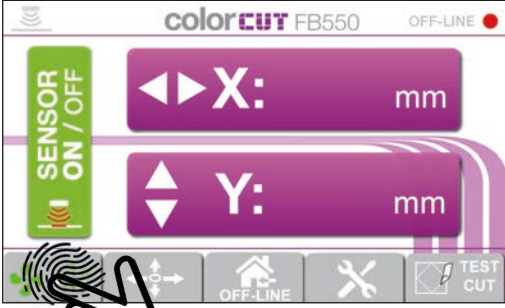
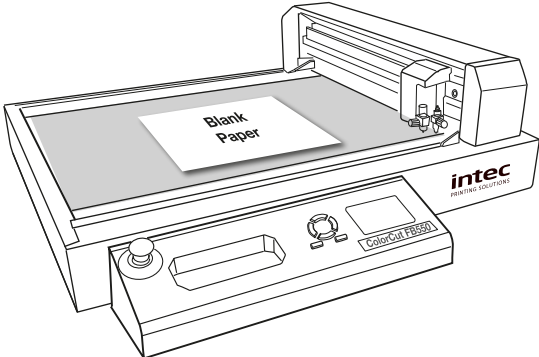

3.5.2 Calibration of the Sensor Offset to the Cutting Blade

- 4.** Place a Blank sheet of A4 / US Letter paper in the middle of the cutting table.



- 5.** Turn on the vacuum hold, by pressing the Vacuum Tab [ ] (Fan) key on TAB strip at the base of the LCD control panel.

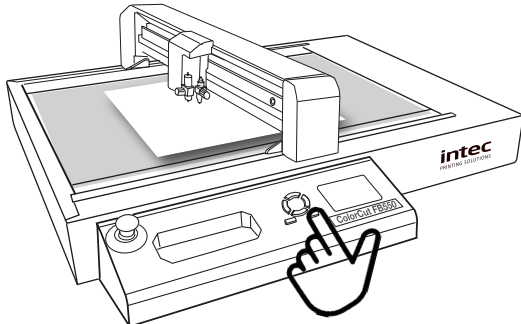

- 6.** Using the **Left / Right** physical keys move the beam over the sheet of paper, then using the **Up / Down** keys move the Tool Carriage to the middle of the piece of paper



- 7.** With the Tool Carriage in the middle of the sheet of paper , press the [ENTER] key twice to set a new ORIGIN point (When you press ENTER key the second time, TOOL2 will briefly activate to confirm).

After pressing [ENTER] 2x the display will r eturn to the HOME screen showing the T ools and their Speed and Force settings.

3.5.2 Calibration of the Sensor Offset to the Cutting Blade

The Sensor Offset Calibration value, is stored in your ColorCut Pro application and so the calibration is performed by ColorCut Pro. To continue the calibration process you will need to launch the ColorCut Pro application and open the [SETTINGS] dialogue box as shown below.

8. Open ColorCut Pro from Windows menu

Open the Windows [START] menu and select ColorCut Pro from the Programs/Intec folder.

The ColorCut Pro splash screen will briefly appear, then the main ColorCut Pro application will be displayed.

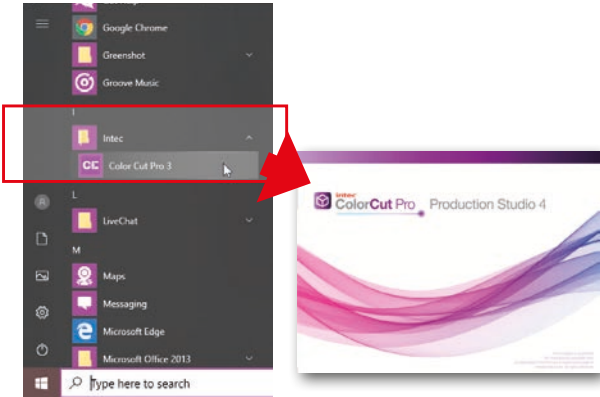

9. The “Vision Sensor Offset” **1** setting provides the ability to calibrate the sensor offset automatically by using the Auto-Find feature **3** AND shows the current setting **2** (which can be manually adjusted if you prefer).

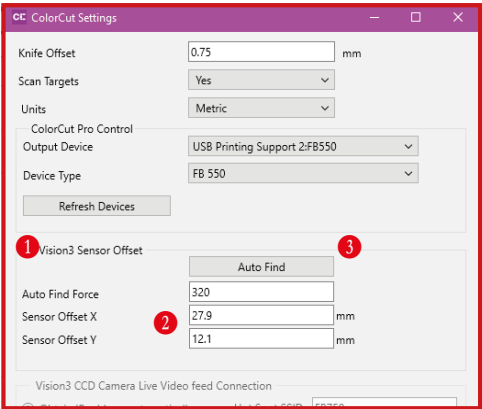

10. Click the [AutoFind] button to start the automatic sensor offset calibration. The ColorCut FB550 will use the Pen Calibration Tool to repeatedly draw a box with a thick frame (D). After drawing the box, it will then scan the frame and automatically enter the values into your Sensor Offset X and Y settings. It will display a message when the process is complete.

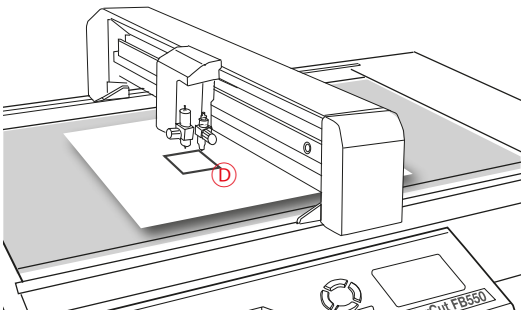

You can now close this window, the calibration for ColorCut Pro is now complete.

3.6 Performing a test cut

The installation of your ColorCut FB550 is almost complete. The final step before starting to learn how to Design, Create and Cut your files using the ColorCut Po software guide (manual 2) is to fit the blade tool in Tool position 1 in place of the Calibration Pen tool and check your Blade depth for the media you will be cutting by performing a test cut.

1. Refer to section 2.4 - Blade Adjustment. Install the appropriate cutting blade in the Blade holder.

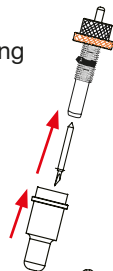
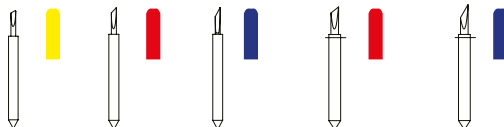

2. Still referring to section 2.4 - Blade Adjustment. Set the blade exposure by adjusting the knob at the end of the Blade holder (Remembering, SET THE BLADE DEPTH/EXPOSURE TO THE LEAST AMOUNT POSSIBLE. Less is MUCH better than more).

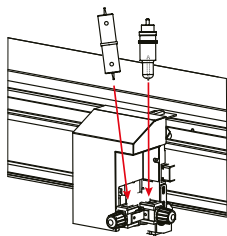
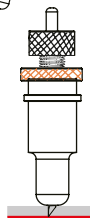

3. Refer to section 3.4 - Installing the Tools. Install the Blade holder in to the Tool carriage in Tool position 1.

4. Place a sheet of the media you plan to cut on the cutting table. Using the LCD control panel on the cutter, press the **MOVE/**  Tab icon along the bottom of the display.

Using the **Left / Right keys** move the carriage so that you can place a sheet of paper on the cutting bed.

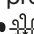
5. Turn on the vacuum hold, by pressing the Vacuum Tab  (Fan) key on TAB strip at the base of the LCD control panel.

6. Using the **Left / Right** physical keys move the beam over the sheet of paper, then using the **Up / Down** keys, move the Tool Carriage to the middle of the piece of paper.

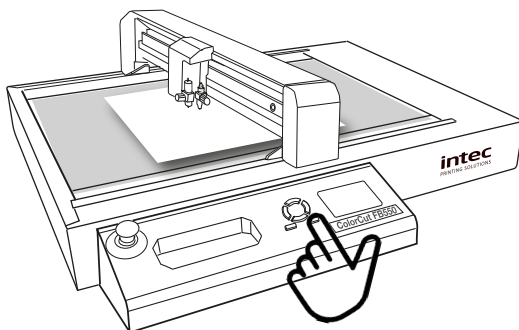

3.6 Performing a test cut (Cont.)

- 7.** With the Tool Carriage in the middle of the sheet of paper , press the **[ENTER]** key twice to set a new ORIGIN point *(When you press ENTER key the second time, TOOL2 will briefly activate to confirm).*

After pressing **[ENTER]** 2x the display will return to the HOME screen showing the Tool's and their Speed and Force settings.

- 8.** Set the pressure for the Creasing Tool **1** so that it is easy to see the crease.
Press the 'touchscreen' panel on TOOL2.

Then use the UP / DOWN keys to set the speed. (to 600mm/s)) and use the Left / Right keys to set the Force. (to 960 g)

The press the **[ENTER]** key to accept the settings.

- 9.** Set the pressure for the Cutting Tool **2** so that it is appropriate for your media (to cut through).
Press the 'touchscreen' panel on TOOL1.



Then use the UP / DOWN keys to set the speed. (to 600mm/s)) and use the Left / Right keys to set the Force. (Start at approx. 360 g)

When cutting through your media the aim is to have the smallest amount of blade out as possible to achieve the cut and use a reasonable force .



For 350micron card (15pt) we would suggest that the pressure should be set between 300 - 450g. When performing the TEST CUT, if you can cut through with a pressure setting UNDER this value, then you have too much blade exposed. Please reduce your exposure blade.

WARNING: Too much blade exposed, has the following implications:



1. Reduced control while cutting,
2. Tight turns will have an artefact known as 'Ears', particularly on inverted corner cuts, (the blade will 'turn over' lift /drag the card on a sharp corner where it has to double back or change direction abruptly. as the blade has too much width as it rotates so can not do so cleanly.
3. You risk reducing the life of your cutting blade - by forcing the tip into the cutting mat unnecessarily.
4. You will place more wear and tear on your equipment, as the motors require added force, to cut your material AND your cutting mat.
5. You will shorten the life of your cutting mat.

- 10.** The press the **[ENTER]** key to accept the settings.

3.6 Performing a test cut (Cont.)

- 11.** With the Vacuum still ON ([) press the  [TEST CUT] tab to perform a Test Cut so you can check your settings.



- 12.** The cutter, will CREASE a DIAMOND shape , then Cut around this in a square shape  using the blade (Same function as the 'ALIGN TOOL2 to TOOL1' - see section 3.5.2).

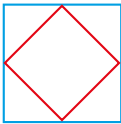

This enables you to double check the two tools are aligned correctly, but more importantly, the square  surround, should cut out perfectly.

If the square  is not cut out, then increase the blade pressure.

If the square  cuts out easily, then reduce the blade pressure, to check you have not got too much blade exposed.

On labels a low pressure is OK, because you are not cutting the backing material.

However in Card, cut through applications, if the blade cuts through at under 300g pressure, then it is likely you have too much blade exposed. Reduce your Blade. (See section 2.4).

If you don't cut through, and have increased your blade pressure to > 600g pressure, then it is likely you do not have enough blade exposed. Increase the amount of blade exposed (See section 2.4).*

* Note: Hard materials, like Polyester sheets, Magnetic media or thicker card, may require more force.

Once you have set the blade depth, and pressure - checking it using the **TEST CUT**, function, you are ready to use your cutter. Please refer to the ColorCut Pro - Production Studio software manual for creating, designing and sending your files to your cutter .

